

Self-Priming Pumps

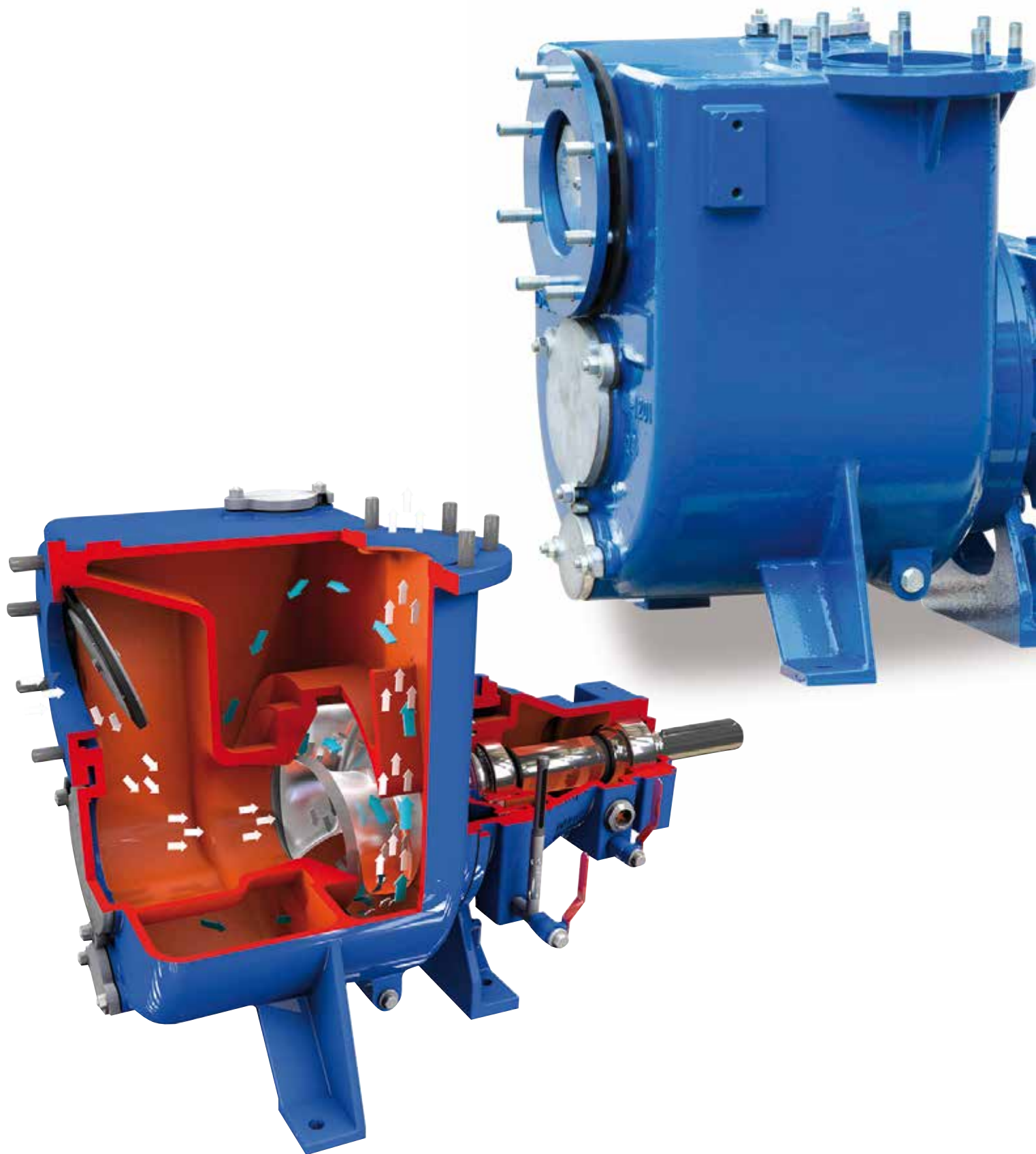

Company Profile

BBA Pumps, servicing the market for over 60 years

BBA Pumps, founded in 1953 in The Netherlands, is a third generation family owned business and dedicated manufacturer of pumping equipment.

Since the early 1980s, BBA Pumps has been building the B-series range of self priming centrifugal pumps for a variety of applications. Featuring an open impeller configuration in combination with a changeable wearplate, facilitating

servicing and minimizing costs of spares. All B series pumps are fitted with a non return valve in the suction port, eliminating the need for a foot valve in suction line and allowing quick priming.



Operation of the self-priming pumps

The rotation of the impeller draws the air present in the suction pipe into the pump casing. The air mixes with the liquid present in the pump casing (see drawing; air = white arrows, liquid = blue arrows). Liquid and air are transported to the discharge outlet.

When all the air has been removed from the suction pipe, the pump draws in liquid. The built-in non-return valve at the suction side prevents the pump casing from being siphoned empty when the pump stops.

In this way, some liquid will always remain in the pump casing, so immediate re-prime is always possible.

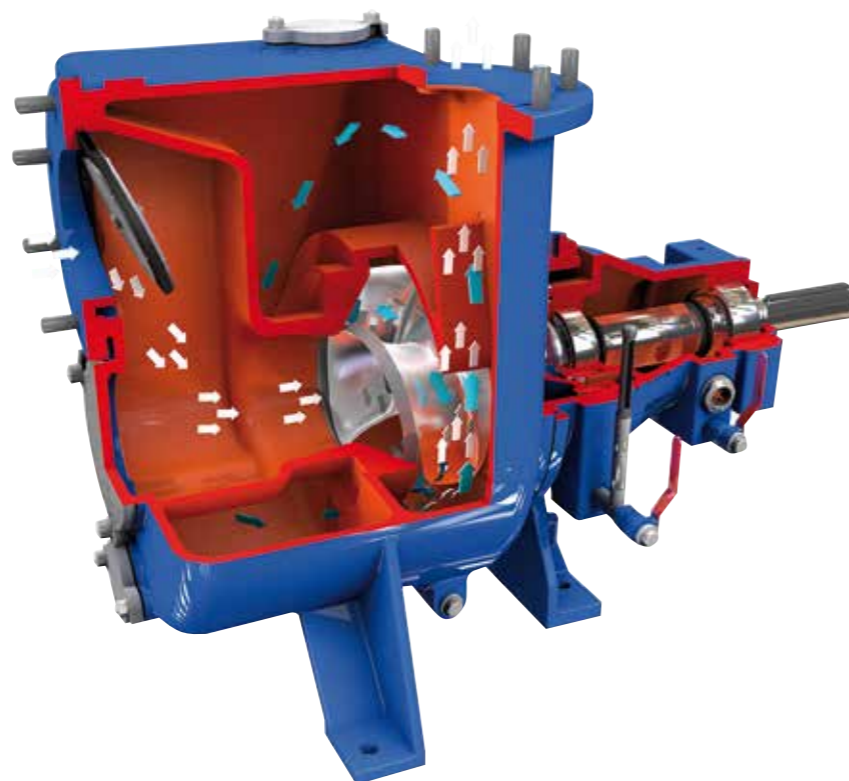

BBA Self-Priming Pumps - B Series

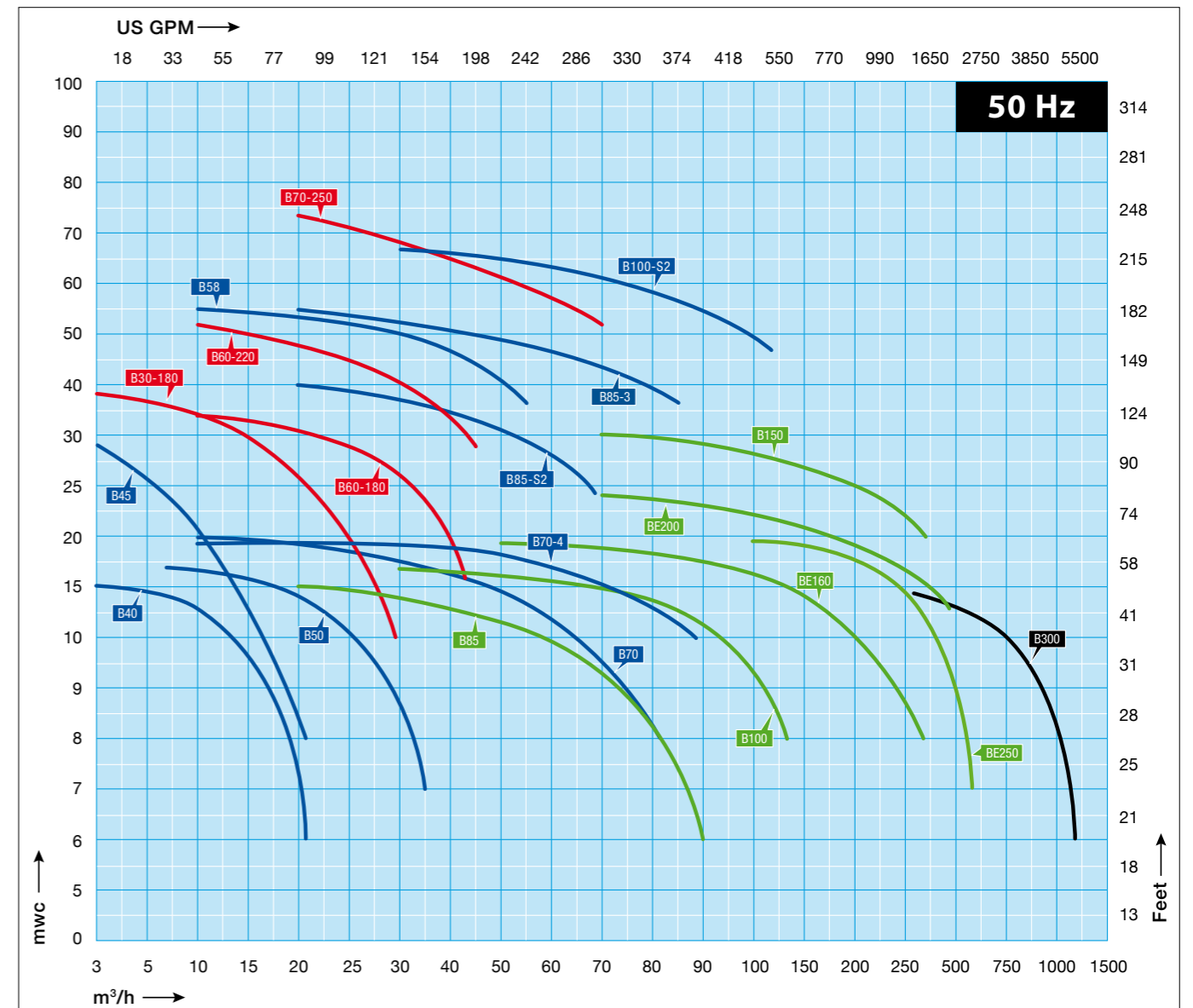

Since the early 1980s, BBA Pumps has been building the B-series range of self priming centrifugal pumps for a variety of applications. Featuring an open impeller configuration in combination with a changeable wear plate, facilitating servicing and minimizing costs of spares. All B series pumps are fitted with a non return valve in the suction port, eliminating the need for a foot valve in suction line and allowing quick priming. Available in sizes from 1" up to 12" with free passages of up to 80 mm (3,15").



Electrically Driven Self-Priming Pumps, 2-Pole

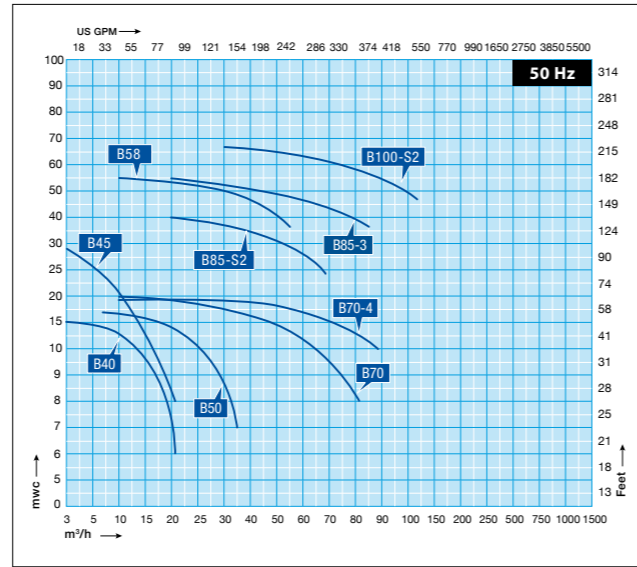

Model	Pump				Motor 400 V 50 Hz		Assembly	
	Flow m³/h	Head mwc	ø mm	Connection		Power kW		Speed rpm
				mm	inch			
B40	21	15	18	40	1,5"	1,5	2850	BVGMC
B45	22	29	14	40	1,5"	2,2	2850	BVGMC
B50	35	18	25	50	2"	2,2	2850	BVGMC
B58	52	62	25	80	3"	11	2950	BVGMC
B70	82	20	22	80	3"	4	2900	BVGMC
B70-4	90	19	30	80	3"	5,5	2880	BVGMC
B85-S2	76	44	15	80	3"	11	2930	BVGMC
B85-S3	86	57	18	80	3"	18,5	2930	BVGSMC
B100-S2	120	62	29	100	4"	30	2950	BVGSMC

Electrically Driven Solids Handling Pumps, 4-pole

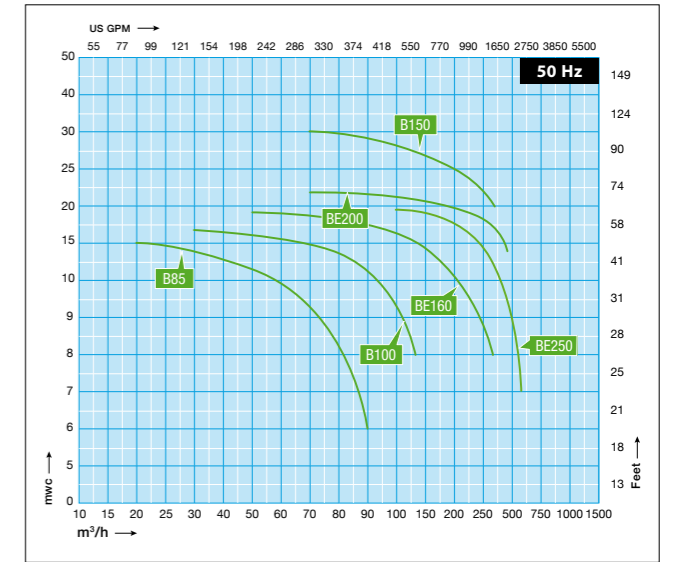

Model	Pump				Motor 400 V 50 Hz		Assembly	
	Flow m³/h	Head mwc	ø mm	Connection		Power kW		Speed rpm
				mm	inch			
B85	90	16	40	80	3"	5,5	1450	BVGMC
B100	140	18	46	100	4"	7,5	1460	BVGMC
B150	300	32	40	150	6"	30	1470	BVGS
BE160	300	17	80	150	6"	15	1460	NMC
BE200	480	24	80	200	8"	37	1475	NMC
BE250	600	21	80	250	10"	37	1475	NMC

Electrically Driven Self Priming High Head Pumps, 2-pole

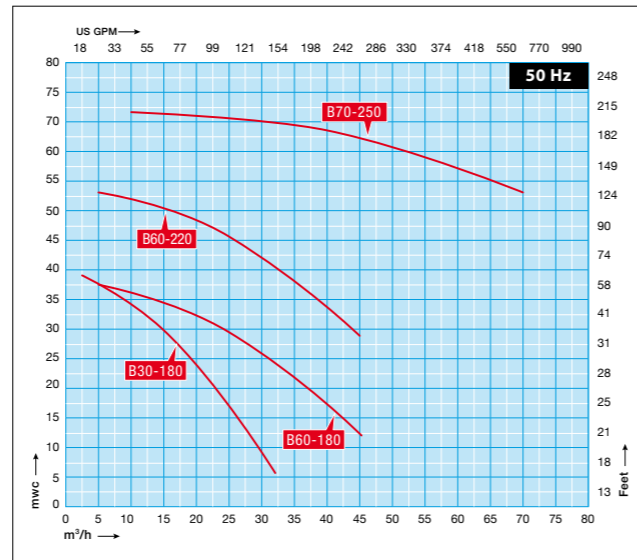

Model	Pump				Motor 400 V 50 Hz		Assembly	
	Flow m³/h	Head mwc	ø mm	Connection		Power kW		Speed rpm
				mm	inch			
B30-180	32	39	12	50-40	2-1,5"	4	2900	BVGMC
B60-180	45	35	18,5	50	2"	5,5	2880	BVGMC
B60-220	45	53	14	50	2"	11	2930	BVGMC
B70-250	70	74	12	80	3"	22	2940	BVGSMC



Features & Optional Features

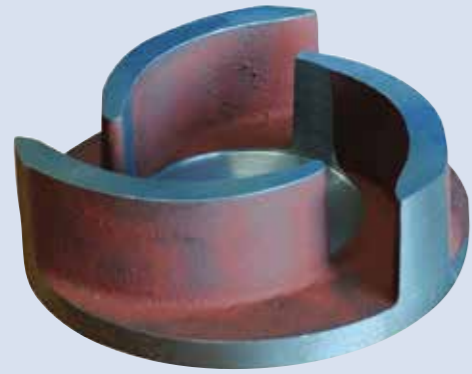

Semi open impeller

The pumps of the BBA B Series are constructed with a semi open impeller which is running against a changeable wearplate. Available in cast iron, bronze and stainless steel.

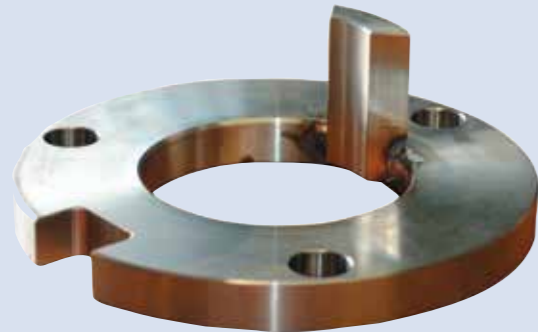

Cutter blade

Several types can be fitted with a stainless steel cutter blade in the impeller for liquids containing fibrous materials.



Stub shaft



Bronze pump casing

Operational Features

Mechanical seals		Extras	
T3W seal	HM / HM / Viton	+F	DIN flanges
MG1 seal	Sic / Sic / EPDM	+FK	DIN, flanges, stainless steel 316
		+B	Bronze impeller, stainless steel 316 shaft
		+BII	Bronze impeller/wear plate, stainless steel 316 shaft
		+KI	Stainless steel 316 impeller and shaft
		+KII	Stainless steel impeller, wear plate and shaft
Gaskets			
N	NBR: Perbunan	+M	Cutting blade
V	FPM: Viton	+P	Perma grease cartridge
E	EPDM	+VP	Grease glass for seal lubrication
T	PTFE: Teflon	+KW	Wheelbarrow frame
K	FFKM, Kalrez	60 Hz	Motor 440 V – 60 Hz



BBA Pumps BV

Edisonstraat 12

7006 RD Doetinchem - The Netherlands

P.O Box 498

7000 AL Doetinchem - The Netherlands

Phone +31 (0)314-368 436

E-mail info@bbapumps.com

Website www.bbapumps.com

Distrimex Pompen & Service BV (Sales the Netherlands)

Edisonstraat 12

7006 RD Doetinchem - The Netherlands

P.O Box 498

7000 AL Doetinchem - The Netherlands

Phone +31 (0)314-368 444

E-mail info@distrimex.nl

Website www.distrimex.nl